

Image of aparatuses

▼Sail-wing-type

Wind Power Generation Apparatus



▲Dual Purpose Vessel

for Wave-Activated Power Generation
and Energy Transportation

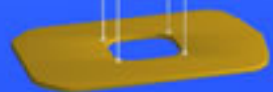

plate weight

▼Sail-wing-type

Wind Power Generation Apparatus



▲Dual Purpose Vessel

for Wave-Activated Power Generation
and Energy Transportation



plate weight

▼Sail-wing-type

Wind Power Generation Apparatus



▲Lure-type Ocean and Tidal Current Power Generation Apparatus



▲Mooring Screw-type

Ocean Current Apparatus



submarine electric cable